

- NOTES**
1. ALL LOT FILLING & EARTHWORKS FOR ROADS IS TO BE COMPLETED PRIOR TO SEWER CONSTRUCTION. THE CONTRACTOR SHALL THEN CHECK FINISHED SURFACE LEVELS IN RELATION TO DESIGN TOP OF MANHOLE LEVELS & ADVISE THE SUPERINTENDENT OF ANY ANOMALIES PRIOR TO PROCEEDING WITH EXCAVATION FOR SEWERS.
  2. ALL SEWER MANHOLES TO BE PRECAST 1050Ø CONCRETE MANHOLES AND TOPS WITH CORAL COAST COMPOSITES FIBREGLASS BASES (OR APPROVED EQUIVALENT) UNO. HEAD OF LINE STRUCTURES TO BE LAMP HOLES (LH) WHERE SHOWN ON LONGITUDINAL SECTIONS.
  3. NOTWITHSTANDING THE FINISHED MANHOLE SURFACE LEVELS SHOWN ON THE LONGITUDINAL SECTIONS, THE LEVEL OF SEWER MANHOLE COVERS SHALL BE ADJUSTED SO AS TO MATCH THE FINISHED SURFACE PROFILES PLUS ANY COUNCIL REQUIRED CLEARANCE ALLOWANCES. NO ADDITIONAL PAYMENT WILL BE MADE FOR THESE ADJUSTMENTS.
  4. PIPE GRADES, LENGTHS AND INVERT LEVELS SHOWN ON THE LONGITUDINAL SECTIONS ARE PROJECTED AT THE SPECIFIED PIPE GRADES TO THE CENTRE OF THE MANHOLE .
  5. SEWERS OVER 2.0m DEEP TO BE COMPACTION TESTED (95% MIN STANDARD COMPACTION)
  6. LOCATION OF HOUSE JUNCTIONS ON MAIN SEWER SHOWN ON LONGITUDINAL SECTIONS MEASURED FROM DOWNSTREAM MANHOLE UNLESS SHOWN WITH CO-ORDINATES ON PLAN VIEW.
  7. CONFIRM CONNECTION LEVELS TO EXIST. SEWERS PRIOR TO COMMENCING EXCAVATION FOR ANY SEWERS.
  8. ALL HOUSE CONNECTIONS DEEPER THAN 2m DEPTH TO HAVE HEAVY DUTY REINFORCED FIBREGLASS JUNCTIONS.

**LEGEND**

- 2/S10 MANHOLE 2; SEWER LINE S1; CENTER CO-ORDINATES
- S-S-S-S- OBLIQUE HOUSE CONNECTION JUNCTION (HC); 150Ø SEWER CL SN8; MANHOLE
- W150 W150 150Ø WATERMAIN WITH FH AND HC
- [Hatched Area] ALLOTMENT FILLING/EXCAVATION. REFER ROADWORKS PLANS
- [Grey Line] STORMWATER
- E-E-E-E- ELECTRICAL LINE AND TURRET
- SSD-SSD-SSD- SUBSOIL DRAINAGE

EXISTING SEWER AND NEW DRAINAGE SERVICES SHOWN GREYED

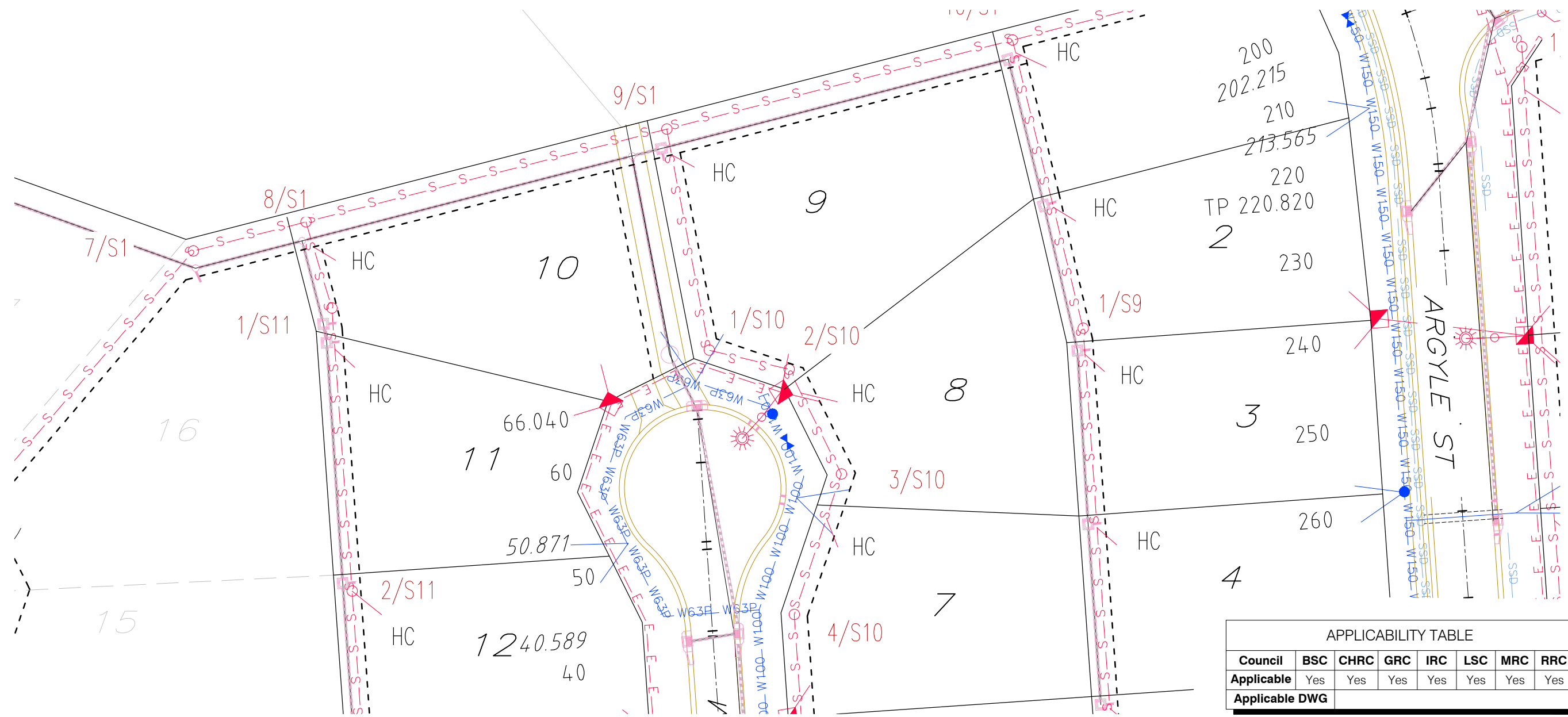

**APPLICABILITY TABLE**

Council	BSC	CHRC	GRC	IRC	LSC	MRC	RRC
Applicable	Yes	Yes	Yes	Yes	Yes	Yes	Yes
Applicable DWG							

**REVISIONS**

REVISIONS	DATE
E IRC ADDED	11/2016
D DELETE NOTE 9 REGARDING ALIGNMENT	10/2016
C GRC AND LSC ADDED	01/2015
B ACCESS CHAMBER BASE TYPE AMENDED	05/2014
A ORIGINAL ISSUE	01/2013

**DISCLAIMER.**  
 The authors and sponsoring organisations shall have no liability or responsibility to the user or any other person or entity with respect to any liability, loss or damage caused or alleged to be caused, directly or indirectly, by the adoption and use of these Standard Drawings including, but not limited to, any interruption of service, loss of business or anticipatory profits, of consequential damages resulting from the use of these Standard Drawings. Persons must not rely on these Standard Drawings as the equivalent of, or a substitute for, project-specific design and assessment by an appropriately qualified professional.

**Capricorn Municipal Development Guidelines**  
 Incorporating:  
 Banana Shire Council (BSC) Livingstone Shire Council (LSC)  
 Central Highlands Regional Council (CHRC) Maranoa Regional Council (MRC)  
 Gladstone Regional Council (GRC) Rockhampton Regional Council (RRC)  
 Isaac Regional Council (IRC)

**SAMPLE DESIGN LAYOUT PLAN**

**ROADS**

STANDARD DRAWING  
 CMDG-S-011

REV.	A	B	C	D	E